

MVL-HF1628M-6MPE

1/1.8" 16mm 6MP FA LENS

HF-E series FA Lens are optimized for machine vision light sources and sensor, with high resolution, excellent image quality, high transmittance and good stability. Featured with fixed focal length, manual aperture and compact size, it is suitable for machine vision industry applications and ideal for industrial cameras.



Key Features

- Higher image clarity and contrast ratio
- Ultra-low distortion and higher relative illumination rate
- Good optical performance at ultra-short working distance
- Compact design, convenient for device integration

Distortion

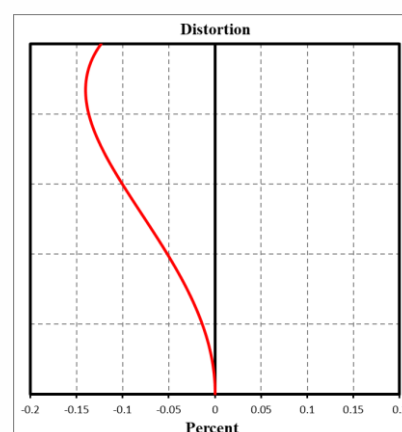

MTF

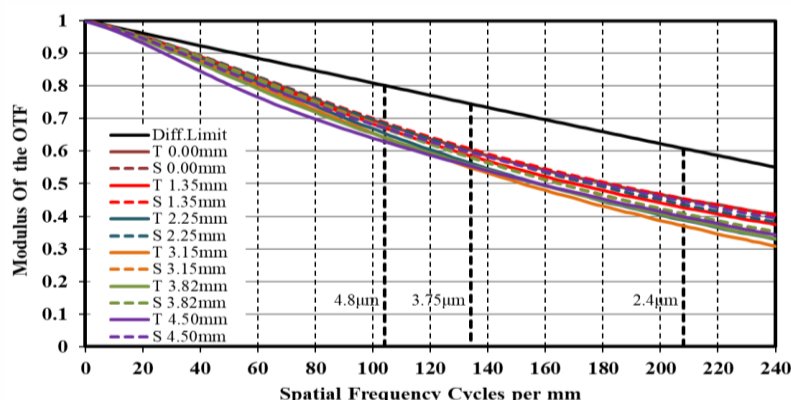

Relative Illumination

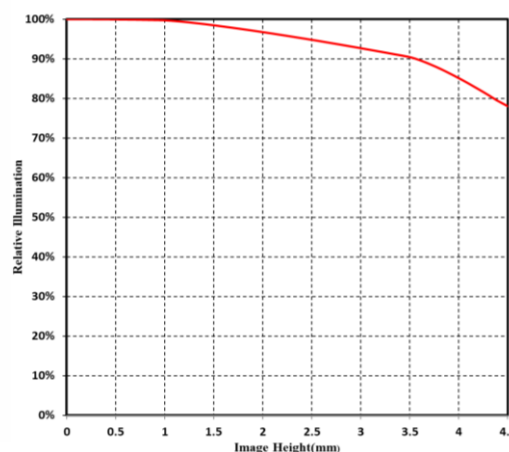

Note: The above curves are the simulate results based on F2.8, $\beta=-0.0515$, WD=300 mm.



Specification

HIKROBOT

Model		MVL-HF1628M-6MPE
Parameter		Fixed focal length, Manual iris, 6MP, FA Lens
Performance		
Focal Length	16 mm	
F-Number	F2.8 ~ F16	
Image Size	Φ9 mm(1/1.8’')	
Distortion	-0.018%	
Minimum Operation Distance	0.1 m	
Field of View	D (8.96mm) : 31.28° H (7.38mm) : 25.94° V (4.92mm) : 17.48°	
Mechanical		
Iris Control	Manual	
Focus Control	Manual	
Filter Thread	M27×P0.5	
Mount	C-Mount	
Flange Back Length	17.526 mm	
Dimension	Φ33×31.9 mm	
Weight	56.1 g	
Temperature	-10 ~ 50℃	
General		
Certification	RoHS2.0	

Dimension

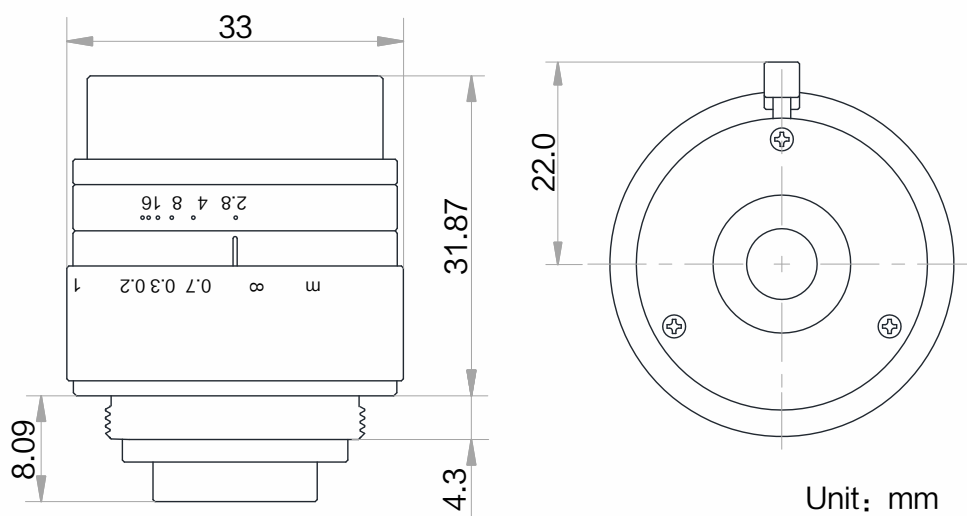

Field of View

Extension (mm)	Working Distance(mm)		Magnification	Field of View(mm)			
				1/1.8"		1/2"	
				H(7.38mm)	V(4.92mm)	H(6.22mm)	V(4.67mm)
5	near	27	-0.476	15.67	10.40	13.17	9.87
	far	44	-0.310	24.02	15.94	20.20	15.13
2	near	50	-0.277	26.84	17.83	22.58	16.92
	far	122	-0.124	59.56	39.64	50.16	37.62
1	near	67	-0.211	35.26	23.43	29.67	22.23
	far	252	-0.062	118.60	79.04	99.95	75.02
0	100		-0.144	51.38	34.17	43.25	32.43
	150		-0.099	74.67	49.69	62.88	47.16
	200		-0.076	97.70	65.06	82.30	61.75
	250		-0.061	120.63	80.35	101.63	76.26
	300		-0.052	143.49	95.61	120.92	90.75
	350		-0.044	166.32	110.85	140.17	105.20
	400		-0.039	189.12	126.07	159.40	119.65
	450		-0.035	211.91	141.27	178.62	134.09
	500		-0.032	234.69	156.48	197.83	148.52
	550		-0.029	257.46	171.67	217.04	162.95
	600		-0.026	280.22	186.87	236.23	177.37
	650		-0.024	302.98	202.05	255.43	191.79
	700		-0.023	325.73	217.24	274.62	206.20
	800		-0.020	371.23	247.61	312.99	235.03
	900		-0.018	416.72	277.97	351.36	263.85
	1000		-0.016	462.20	308.33	389.72	292.66

HIKROBOT

Hangzhou Hikrobot Technology Co., Ltd.

No.399 Danfeng Road, Binjiang District, Hangzhou 310051, China.

en.hikrobotics.com

Copyright Hikrobot

Hangzhou Hikrobot Technology Co., Ltd. All Rights Reserved. Hangzhou Hikrobot Technology does not tolerate any infringement. Any organization or individual may not imitate or reproduce in whole or in part of the content. The data herein is based on Hikrobot's internal evaluation. Actual data may vary depending on specific configuration and operating condition. The information herein is subject to change without notice. All the content has been checked conscientiously. Nevertheless, Hikrobot shall not be liable to damages resulting from errors, inconsistencies or omissions.